

User manual

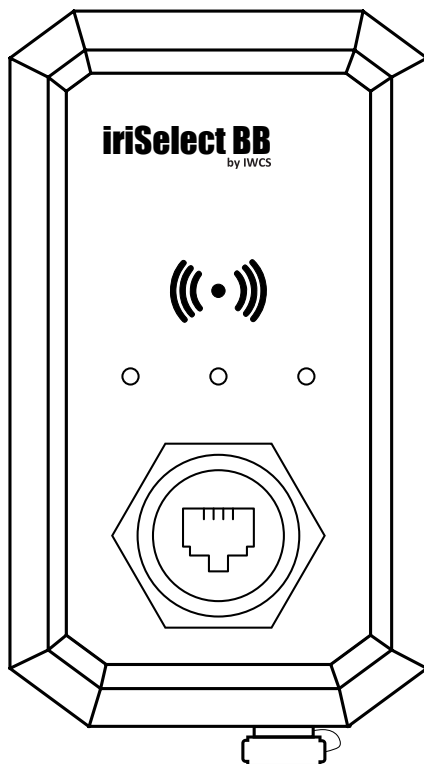

v.1.1.1

iriSelect Black Box

CONGRATULATIONS ON YOUR NEW PRODUCT FROM
IRIDIUM WATERPROOF COMMUNICATION SYSTEMS

iriSelect Black Box

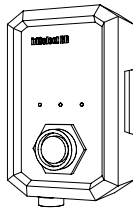

IWCS HOPE YOU WILL ENJOY THE BENEFITS
OF TROUBLE FREE HIGH QUALITY INTERCOM.
PLEASE READ THESE INSTRUCTIONS
CAREFULLY BEFORE FIRST USE.

IF INSTALLED, OPERATED AND MAINTAINED
ACCORDING TO THIS MANUAL, iriSelect Black
Box WILL BE A RELIABLE PARTNER IN MANY
YEARS TO COME.

THOMAS B SVENNINGSEN
CO-FOUNDER OF IWCS

1. Introduction

1.1 Disclaimer	Page:	5
1.2 Copyright	Page:	5
1.3 Trademark	Page:	5
1.4 Safety Warning	Page:	6

2. Unboxing

2.1 What's in the box	Page:	7
-----------------------	-------	---

3. Installation

3.1 Installing the Bracket	Page:	8
3.2 Drill Template	Page:	9
3.3 Bracket Placement	Page:	11
3.4 Screws	Page:	12
3.5 Drilling Holes	Page:	12
3.6 Installing the iriSelect Black Box	Page:	13

4. Connection options

4.1 Connection options	Page:	14
4.2 Wired Connection	Page:	14
4.3 Wireless Connection	Page:	14

5. Ethernet Connection

5.1 Cable installation	Page:	15
5.2 LEDs Wired Connection	Page:	17

6. Wireless Connection

6.1 Connect to iriSound	Page:	18
6.2 LEDs Wireless Connection	Page:	18
6.3 Connect to iriSelect Black Box	Page:	19
6.4 Change Connection mode	Page:	20

7. Client Connection

7.1 Connect to iriSound	Page:	21
7.2 Access Settings site	Page:	21
7.3 Set to Client mode	Page:	21

8. Access Settings site

8.1 Ways to Access	Page:	22
8.2 Option #1	Page:	22
8.3 Option #2	Page:	22

9. Settings Site

9.1 Hardware Settings	Page:	23
9.2 Radio Settings	Page:	24
9.3 Grid Settings	Page:	26
9.4 Devices	Page:	28

10. The Interface

10.1 Understanding the interface	Page:	30
10.2 Grid Section	Page:	31
10.3 Radio Section	Page:	32
10.4 Stealth	Page:	32
10.5 Error	Page:	32
10.6 AVAD	Page:	33

11. Grid Site

11.1 Grids	Page:	34
11.2 Save Button	Page:	34
11.3 Grid Editing	Page:	35
11.4 Grid Menu Bar	Page:	35

13. Service & Maintenance

13.1 Maintenance	Page:	38
13.2 Updating the iriSelect Black Box	Page:	38
13.3 Troubleshoot	Page:	40

14. Technical Data and Drawings

14.1 Specifications	Page:	40
14.2 Measurements	Page:	41

1.1 Disclaimer

Any responsibility or liability for loss or damage in connection with the use of this product and the accompanying documentation is disclaimed by IWCS.

The information in this manual is provided for informational purposes only, is subject to change without notice and may contain errors or inaccuracies.

Manuals issued by IWCS are periodically revised and updated. It is recommended that anyone relying on this information acquires the most current version by requesting it at info@iwcs.eu.

IWCS is not responsible for the content or accuracy of any translations or reproductions, in whole or in part, of this manual from any other source.

Graphics and layouts may vary depending on the MFD (Multi-Function Display), tablet or mobile device you are using, as well as the versions of software installed. The appearance, functionality and user interface elements may differ based on the specific device and software configurations. Please note that the illustrations, screenshots or examples provided in this documentation are for general reference and may not precisely reflect the actual user interface or display on your specific device.

This product should only be installed by professionals. IWCS cannot be held responsible for any system malfunctions or damages resulting from improper installations. It is recommended to seek assistance from qualified technicians or authorized personnel to ensure the correct installation and operation of the product.

1.2 Copyright

2023 Iridium Waterproof Communication Systems ApS. All right reserved.
Printed in Denmark.

1.3 Trademark

iriSelect Black Box is a Trademark by Iridium Waterproof Communication Systems ApS.

Revision	Date	Description
1.0	27-06-2023	
1.1	01-02-2024	Address Changed
1.2	15-02-2024	Firmware v.1.1.0
1.3	04-04-2024	Firmware v.1.1.1
1.4	09-04-2024	Firmware v.1.2.0
1.5	13-01-2025	Firmware v.2.2.0/1.2.0

1.4 Safety warning

The following general safety precautions must be observed during all phases of operation, service and repair of this equipment. Failure to comply with these precautions or with specific warnings elsewhere in this manual violates safety standards of design, manufacture and intended use of the equipment. IWCS assumes no liability for the customer's failure to comply with these requirements.

- **EMC / RF EXPOSURE**

iriSelect Black Box is CE and UKCA certified as stated in the Declaration of Conformity, which is included in this manual.



- **FIRE**

In case of fire, harmful gases and fumes may occur. One should immediately leave the area and seek help. In case of suspected smoke in the lungs, a doctor should be consulted.



- **POWER LOSS**

In the event of a power outage, iriSelect Black Box will turn off and will automatically restart when power is restored. Power interruptions limited to iriSelect Black Box will not affect other users communication. A general power outage will turn off the entire intercom system. IWCS is not responsible for any power outages or consequences thereof, of any kind.



- **WARRANTY LIMITATIONS**

IMPORTANT - This unit is a sealed waterproof unit (classified IPX7). To create and maintain its waterproof integrity it has been assembled in a controlled environment using special equipment. This unit is NOT a user serviceable unit and under no circumstances should the unit be opened except by authorized personnel. Unauthorized opening of the unit will invalidate the warranty.



- **DISPOSAL**

When disposing of iriSelect Black Box and related equipment, it must happen in accordance with applicable national law.



2.1 What's in the box

1 x iriSelect Black Box

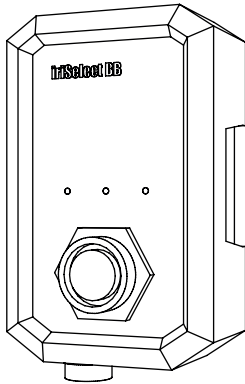

1 x Mounting Bracket

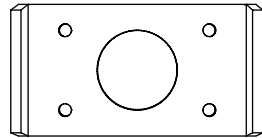

1 x Magnet

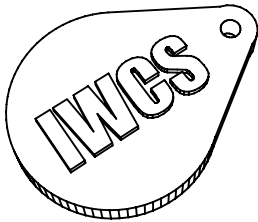

1 x User Manual

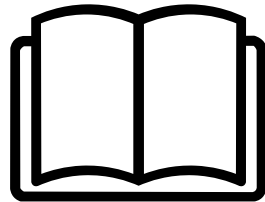

3.1 Installing the Bracket

Before installing the iriSelect Black Box, it's essential to determine whether you will be using it via a LAN cable or its internal WiFi hot spot. If you opt for a LAN cable connection, ensure that you have ample space for the cable to connect to the front of the iriSelect Black Box and consider the length of your LAN cable. If you choose to utilize the internal WiFi, it's crucial not to hide the unit to maintain a stable connection between the iriSelect Black Box and your MFD (Multi-function display), mobile device or computer.

Placing the Bracket

The bracket serves as a secure mounting solution for the iriSelect Black Box. It is crucial to ensure that sufficient space is provided around the bracket to accommodate cables and wiring. For detailed instructions on installing the bracket, please refer to page 8, where you will find a helpful 1:1 template indicating the precise hole locations.

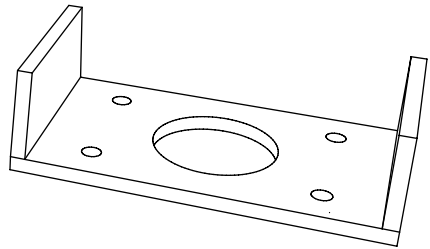

Screws and holes

After determining the desired location for the iriSelect Black Box, select screws that are appropriate for the surface you will be mounting it on to. Depending on the material, you may need to drill holes prior to securing the bracket. Ensure the screws provide a secure hold to keep the iriSelect Black Box in place.

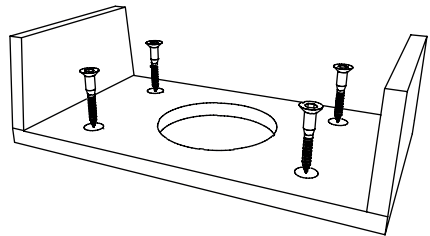



3.2 Screw holes 1:1

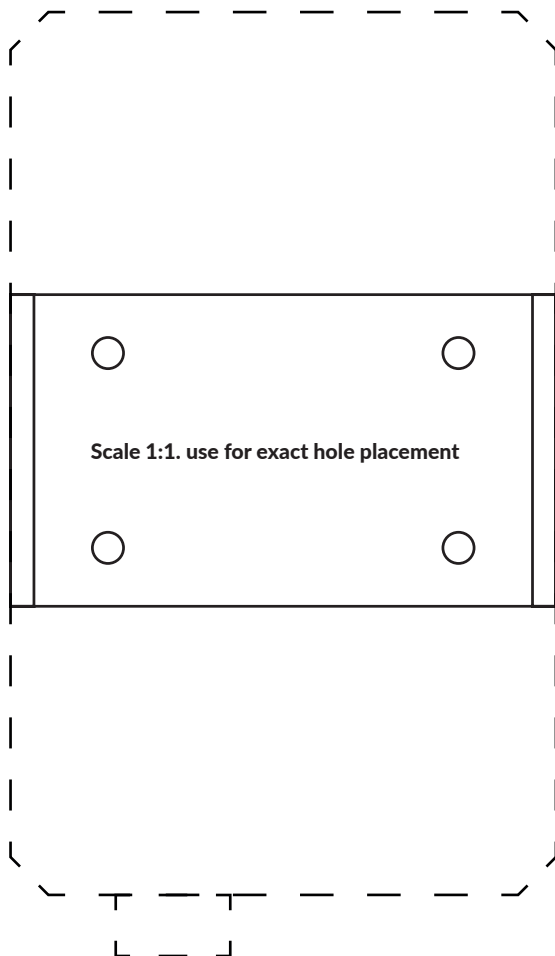



Backside of drill template

3.3 Bracket placement

The minimum distance from the underside of the bracket to the nearest surface should be no less than **150 mm** to ensure proper cable clearance.

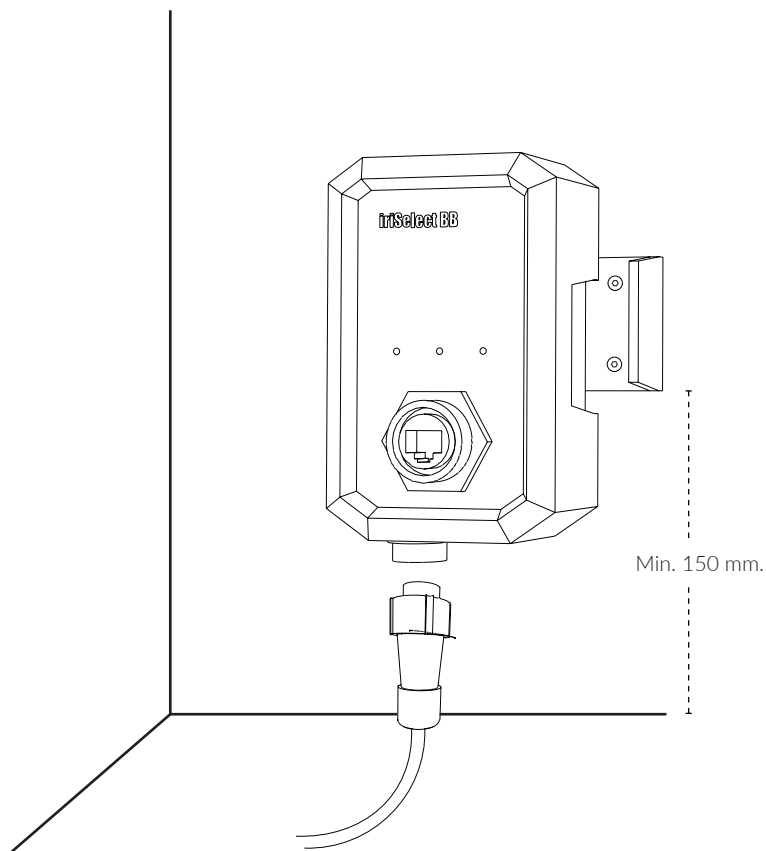

3.4 Screws

Flat head counter sunk screws



Round headed screws

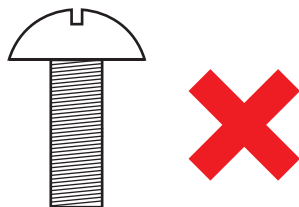

3.5 Drilling holes

When mounting the bracket for the iriSelect Black Box, it is essential to consider the material and the appropriate drill bit size. Please note the following guidelines:

If you are using wood screws you will need:

- 4x 4 mm screws.
- Drill 3.3 mm holes.

If you are using machine screws you will need:

- 4x 4 mm screws.
- 4x locking bolts
- 4x washers.
- Drill 4.5 mm holes.

By using the recommended screw size and drill bit size, you can ensure a secure and proper installation of the bracket for the iriSelect Black Box.

3.6 Installing the iriSelect Black Box

Once the bracket is securely in place, you can proceed to inserting the iriSelect Black Box into the designated slot. You might need to wiggle the iriSelect Black Box slightly to make it fit between the bracket arms.

Securely in place

Gently use your hands to apply pressure and push the iriSelect Black Box into place within the bracket. Ensure a firm and secure fit by pressing it all the way until you feel a snap, indicating that it is properly seated in the sockets. It is important to note that this should be done manually without the use of any tools. Avoid excessive force or using tools as it may cause damage to the device or bracket.

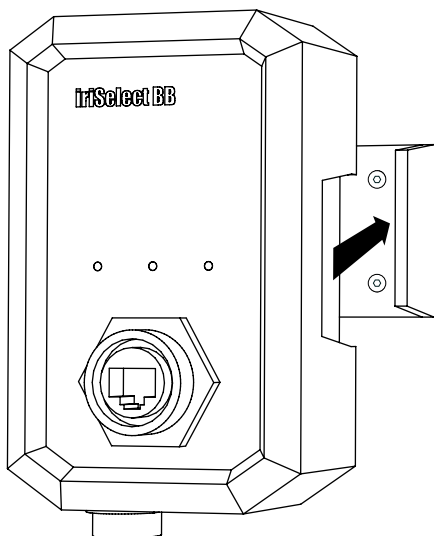

4.1 Connection Options

There are two main options by which you can connect your iriSelect Black Box to your MFD/PC it is wired and wireless.

Out of the box, the iriSelect Black Box is preset to 'Ethernet' (wired) connectivity. This is also our recommendation to ensure a stable connection. Refer to page 15 for more information.

If you wish to establish a wireless connection, you have two options depending on your type of MFD. For a standard wireless connection using WiFi, refer to page 18. This connection is recommended if you intend to use your iriSelect Black Box via a PC or a tablet. Some newer MFDs also support this functionality.

The other option is also a WiFi connection but utilizes your MFD's local WiFi accesspoint. This is recommended if you are looking to set up a wireless connection from your MFD to the iriSelect Black Box. Please refer to page 21 for instructions.

4.2 Wired Connection (Default)

Are you doing a wired connection, please go to page 15.

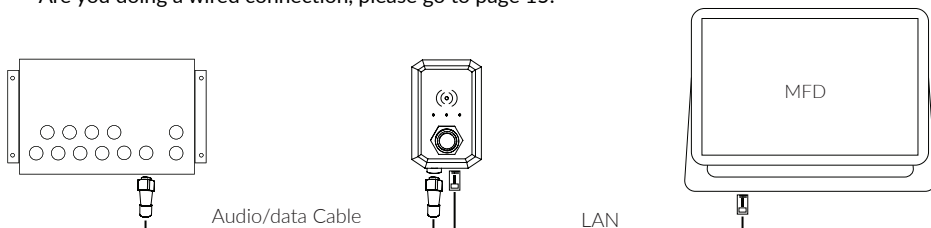

**This way of connection will NOT send out any visible SSID*

4.3 Wireless Connection

Are you doing a wireless installation, please go to page 18.

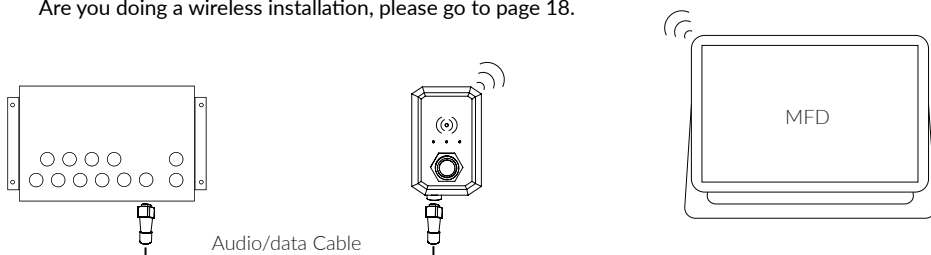

5.1 Cable installation

Once the iriSelect Black Box is securely installed, you can proceed with inserting all the necessary cables. To ensure proper connections and waterproofness, please follow the steps below carefully.

1. Insert data cable

Align the white dot on the cable connector with the white dot on the flush connector. Press firmly until the connectors are fully engaged.

2. Turn to lock in place

Twist the end of the cable connector until you feel a click. This step is important to ensure waterproofness.

3. Connect to iriSound

The other end of the data cable goes into the iriSounds AUX2 slot.

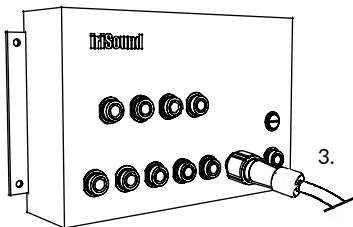
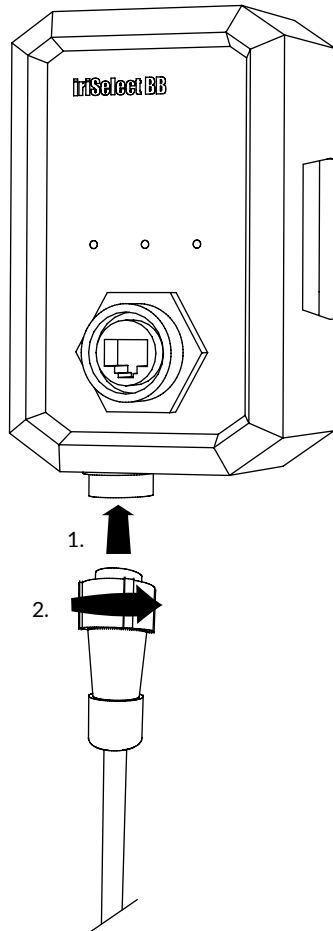

1. Insert LAN cable

Align the white dot on the LAN cable connector with the corresponding white dot on the flush connector. Push the connector until it is fully inserted.

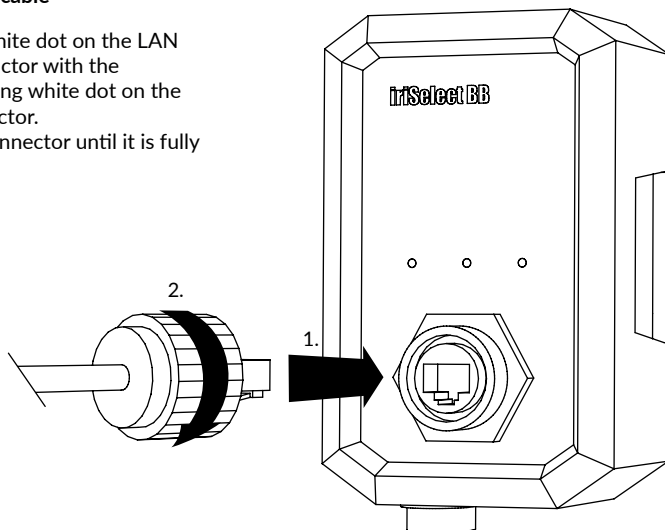

2. Tighten connector

Tighten the connector according to cable manufacturer's instructions. This is important to ensure waterproofness.

3. Connect to MFD / Computer

Connect the other end of the cable to either a Multi-Function-Display (MFD) or a computer. Once the connection is established, the MFD will automatically detect the iriSelect Black Box and install the necessary software.

If you are connected to a PC, open a browser and type "iriselect.local" in the search bar

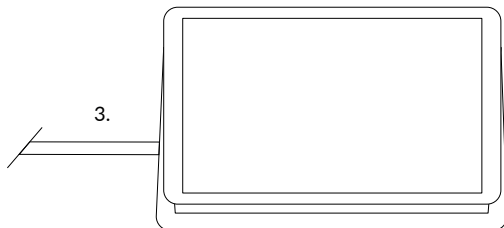

5.2 LED - Wired connection

When your iriSelect Black Box is connected the two LED's (middle and left) should flash green.

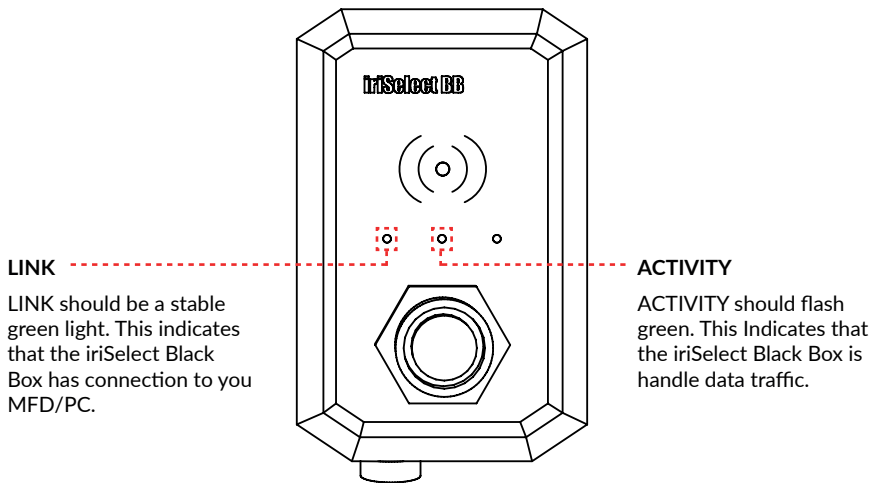

18 Wireless Connection

6.1 Connect to iriSound



Start by connecting the iriSelect Black Box to your iriSound just like shown on page 15 to provide power to the unit. The LED on the right side should start flashing.

6.2 LEDs - Wireless connection

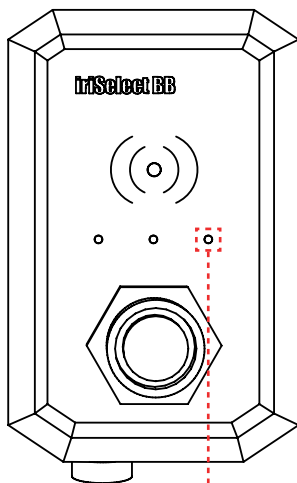
When making a wireless connection between the iriSelect Black Box and your MFD/PC it is important to be aware of the LED on the right. This should also be the only one flashing during this process.



LED Indicator

1. The iriSelect is not connected to anything the LED to the right will flash:
"3 short flashes, long break"

2. The iriSelect Black Box flashes 3 times in a row. Indicating it is sending out a WiFi.

3. The iriSelect Black Box has a steady red light. Indicating it is connected to a MFD/PC.

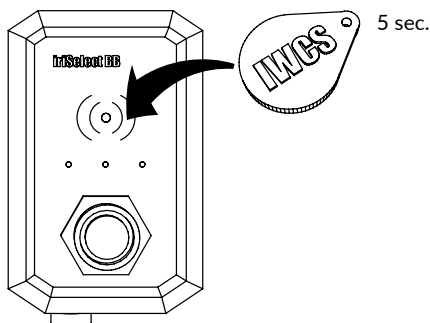
6.3 Connect to the iriSelect Wireless

To activate the local WiFi of the iriSelect Black Box and make it visible when scanning for WiFi's, simply hold the provided magnet over the WiFi icon located on the front of the device. Hold the magnet for 5 sec. until the right LED has a steady red light, then remove the magnet.

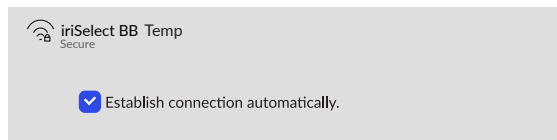

The iriSelect Black Box is now sending out a WiFi named 'iriSelect Temp'. This is a temporary WiFi for settings purposes only.



Once connected to "iriSelect Temp" WiFi open a browser and type "iriSelect.local" in the search bar.



You should now be able to see the interface on our screen.

6.4 Changes connection mode

As default the iriSelect Black Box is set to run a Ethernet cable, but we can changes this to a wireless mode instead. To changes this you will have to access the settings menu on the interface. While still connected to the "iriSelect Temp" WiFi and you have a browser open with the interface running, hold the magnet to the iriSelect Black Box for 1 sec. A settings icon will appear in the lower left corner on your screen.

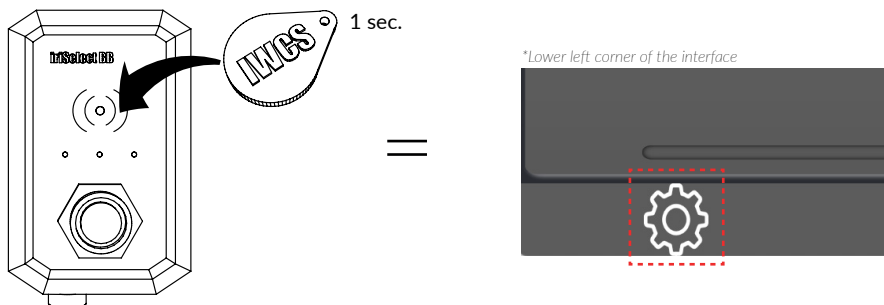

When clicked your screen will split into two parts. one still containing the interface, the other containing the settings site.

Under "Hardware Settings - Network Mode". Changes "Ethernet" (Default) to "WiFi Accesspoint"

You will now loos connection to your iriSelect Black Box. To reconnect, go to you WiFi and look for the WiFi "iriSelect BB". The default password is "**password**".

Now you can access the "iriselect.local" page from your MFD/PC again.

To scan for WiFi on your MFD please refer to the user manual provided with this.

7.1 Connect to iriSound

Start by connecting the iriSelect Black Box to your iriSound just like shown on page 15 to provide power to the unit. The LED on the right side should start flashing.

7.2 Access settings site

To access the settings site please refer to page 22.

7.3 Set to Client mode

From the settings menu **"Hardware Settings"** set the Network Mode to **"WiFi Client"**.

Once the iriSelect Black Box is set to **"WiFi Client"**, click the **"Scan SSIDs"** button.

A list of all visible WiFi will show up. Now choose the WiFi you wish to connect to and type in the password if needed.

NOTE: This requires you to have a WiFi Accesspoint on your vessel/vehicle or that your MFD can act as a WiFi Accesspoint. To Find out how to set your MFD to WiFi Accesspoint please refer to the manual provided with your MFD.

Once you have established a connection between your MFD and iriSelect Black Box, your MFD will automatically detect the iriSelect Black Box and show the Intercom app.

please note that some MFD's requires independend setup on the MFD itself. Please refare to the user manual provided with your MFD.

8.1 Ways to access settings

There are two different way to access the settings site.

1. The first options, which also is the recommended, being from your PC or MFD, directly from the interface.
2. The second options lets you access the settings from a browser if you type in "iriselect.local/settings" when connected to your iriSelect Black Box.

8.2 Option #1 (recommended)

The first option can be done from your MFD, PC, Tablet or Phone.

When connected to the iriSelect Black Box, simply open the app on your MFD, or if your are on PC or tablet go to "iriselect.local". now you take the magnet and place in on the iriSelect Black Box for **1 second** like shown below.

Now a settings icon will appear in the lower left corner of the interface screen. When you click this, your screen will split into two, with your settings site on the right side and interface on the left.

The benefits of doing it this way, is that every time you press "update", your changes will be shown on your interface instantly.

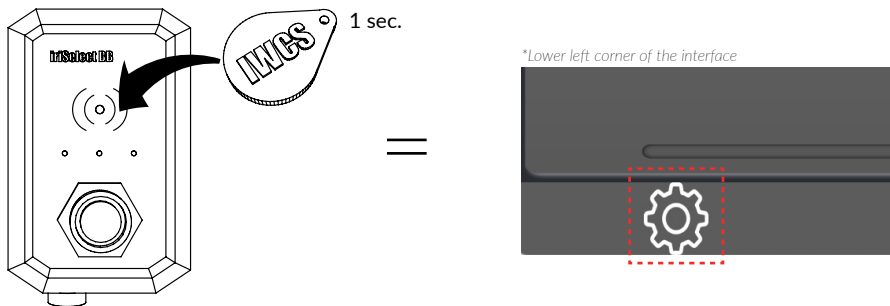

8.3 Option #2

The second option being, while connected to the iriSelect Black Box, you open a browser on your PC or tablet and go to "iriselect.local/settings".

This will open up the settings site, from where you can make all your desired changes to your interface. Note that this does not allow you see your changes while you are making them as you can with the option above.

9.1 Hardware Settings

Network Mode:

Choose how you wish connect to your iriSelect Black Box. The default is "Ethernet" and requires a LAN-cable from your iriSelect Black Box to your router or MFD.

WiFi Access point mode:

This is only necessary if you have set connection type to "WiFi Accesspoint"

WiFi Client mode:

This is only necessary if you have set connection type to "Client Mode"
Use the Scan SSIDs button to scan for nearby SSIDs. Locate the SSIDs you wish to connect to and type in password if needed.

Update

When you have chosen your desired connection method, click "update".

Network Mode:
Connection type:
WiFi Accesspoint

WiFi access point mode:
AP SSID:
iriSelect BB
AP Password:
password
AP Channel:
6

Wifi Client mode:
Scan SSIDs
Frederik - iPhone
Password:
Update

9.2 Radio Settings

Under the radio settings, you have the ability to set up and configure your different radios. This includes assigning names and descriptions to each radio for easy identification and quick usage. Furthermore, the radio settings also determine which radios will appear on your home screen.

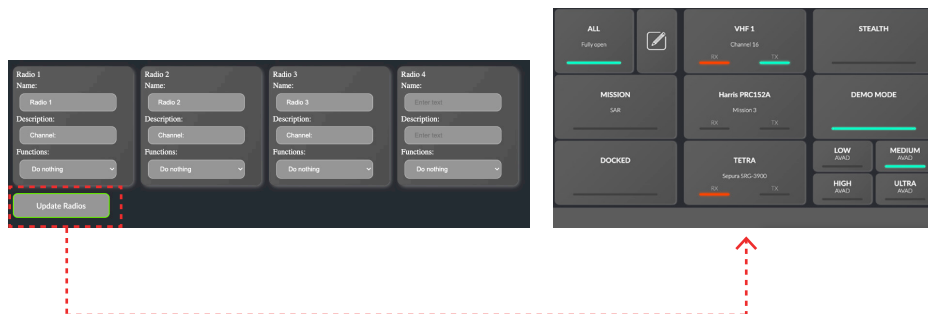

Please note that the radio connected to the lowest channel number on your IriSound should always be assigned as "Radio 1" in the radio settings. Meaning, if you have radios connected to channels 6, 7, and 8 on your IriSound, you should configure them as followed:

"Radio 1" = radio connected to channel 6 on the IriSound.

"Radio 2" = radio connected to channel 7 on the IriSound.

"Radio 3" = radio connected to channel 8 on the IriSound.

This configuration ensures that the assigned radio names correspond to the physical connections on your IriSound. Please refer to your schematic.

Setting up radios

1: Give radio name

This name will appear on the "Radio 1" Button on your home screen.

2: Add description

The description will appear underneath the name on the "Radio 1" button on your home screen.

3: Functions

The "Function" feature customizes the behavior of your radio when you press the button on the home screen, allowing you to assign specific actions for quick access.

*Settings site -Radio settings

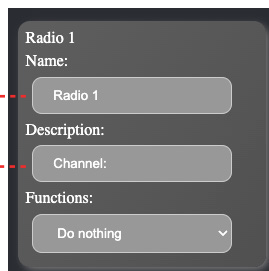

Radio 1

Name:

Radio 1

Description:

Channel:

Functions:

Do nothing

*Home Screen on MFD

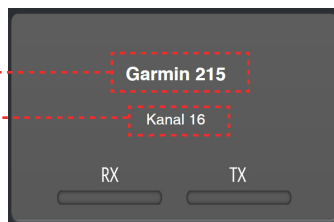

6: Continue with radio 2, 3, 4

5: Press update when done

Make all your desired changes and press "Update".

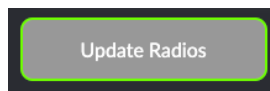

*If you don't give name your radios, these will not appear on your MFD.

9.3 Grid Settings

In the grid settings, you have the flexibility to determine the number of grids you would like from 1 to 8, the named grids will be visible. These grids will appear on the left side of your home screen, providing convenient access to different talk groups or communication channels. By configuring the grid settings, you can customize the layout and organization of your talk groups to suit your specific needs.

The grids layout is edited directly from the Multi-Function Display (MFD) or a compatible device.

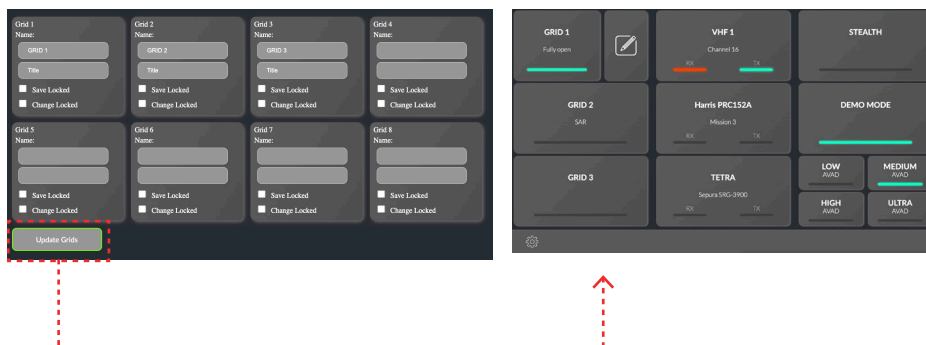

Setting up grids

1: Set grid name

*Settings site - Grid settings

2: Set grid description

3: "Save Locked"

When checked on the user is not allowed to save changes made to the grid, but can still be edited. It will change back to default when you switch grid.

4: "Change Locked"

When checked on the user is not allowed change the grid. They will still be able to open the grid and see its layout.

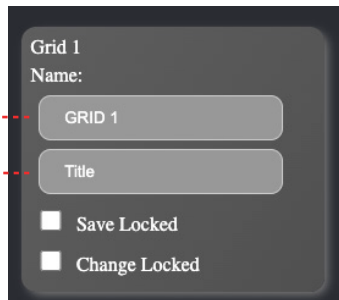

*Home Screen on MFD

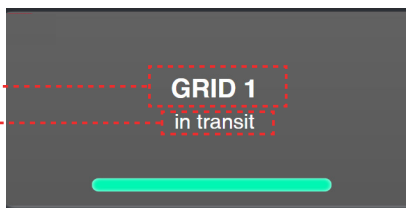

5: Continue with grid 2, 3, 4,....

6: Press update when done

Make all your desired changes and press "Update".

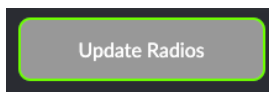

9.4 Devices

In the grid size menu, you have the option to customize the size of your grids based on your specific needs. This feature takes into account the number of headsets and radios you have connected to the iriSound. By selecting the appropriate grid size, the system will automatically adjust to accommodate the maximum number of accessories you have.

The maximum size of your grids is 10x10.

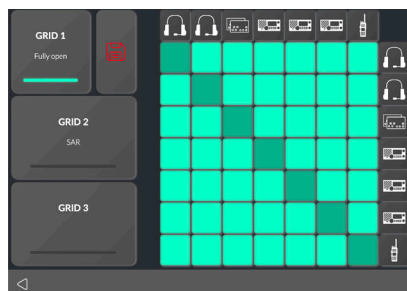
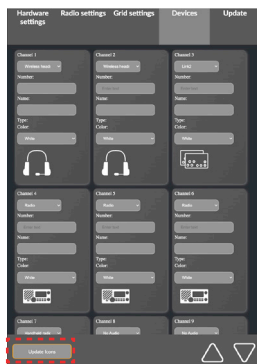

When configuring your grid size, it is crucial to ensure that the order of settings match the physical installation. Please refer to your schematic.

Setting up devices

*Settings site - Grid size

1: Set Icon Type

2: Set Icon Numbe (Optional)

3: Set Icon Name (Optional)

4: Set icon color (Optional)

Channel 1

Wireless head:

Number:

Name:

Type:

Color:

White

5: Continue with channel 2, 3, 4,....

*Edit Grid Site on MFD

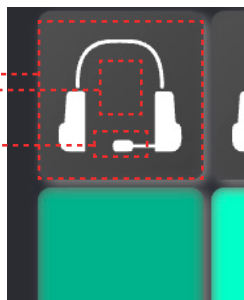

6: Press "Update" when done

Make all your desired changes and press "Update".

Update Radios

30 The Interface

10.1 Understanding The Interface

Home Screen

The home screen is your central control hub, providing full control over your intercom system. It displays active radios, enables push-to-talk functionality, offers AVAD controls, integrates phone calls and features a user-friendly interface for easy operation.



Graphics and layout may vary depending on the MFD (Multi-Function Display), tablet or mobile device you are using, as well as the versions of software installed. The appearance, functionality and user interface elements may differ based on the specific device and software configurations. Please note that the illustrations, screenshots or examples provided in this documentation are for general reference and may not precisely reflect the actual user interface or display on your specific device.

10.2 Grids Selection

The "Grid Selector" section provides you with the ability to quickly switch between your preset talk groups. These talk groups are prefigured communication channels that you can customize to meet your specific needs.

Edit Grid

If you want to edit the currently active grid, simply click the "Edit" button displayed on the grid interface.

Active grid

When the grid lighting is green, it indicates that the grid is active and in use.

Inactive grid

When there is no light, it means that the grid is inactive. To activate it, simply click on it. Please note that activating a new grid will deactivate your current grid. It's important to remember that only one grid can be active at a time.

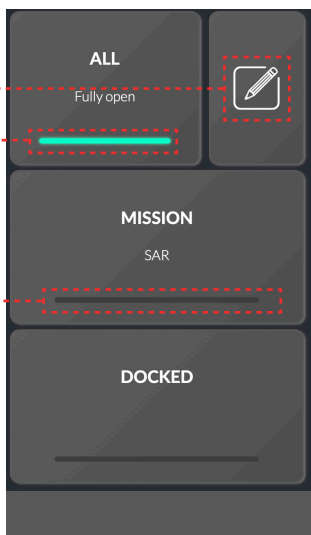

10.3 Radios

The "Radio" section provides you with a comprehensive overview of all your active radios. It allows you to monitor and keep track of each radio in real-time. This feature enables you to see which radios are currently being engaged in communication, providing valuable situational awareness. Additionally, the radio tabs within this section also serve as a convenient Push-to-Talk (PTT) function.

RX

When the RX light is illuminated, it indicates that you are receiving incoming communication on this specific radio.

TX

When the TX light is illuminated, it means that you can now transmit or talk out on this particular radio. Please note that this functionality is active only when the push-to-talk (PTT) button is held in.



10.4 Stealth

When the "STEALTH" mode is activated, it will turn off all lights on your IWCS intercom system including headset LED's.



10.5 Error

The "ERROR" indicator will alert you if there is a loss of connection to a headset or an other device has been disconnected from your intercom system.

"B" Error's refer to a wireless connection has been lost. Ex. headset.

"C" Error's refer to a channel on your iriSound has lost its connection. Ex. a cable has been pulled out.

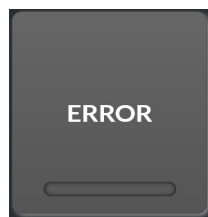

10.6 AVAD

AVAD (Adaptive Voice Activity Detection) constantly adjusts to the surrounding noise level for optimal communication. Set the AVAD level based on your situation.

The green light indicates what level your AVAD is currently active.

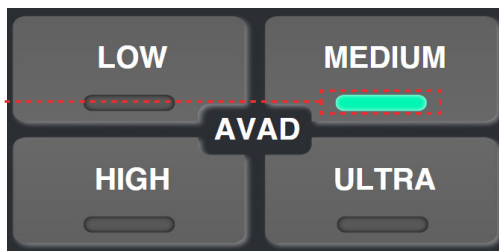

34 Grid Site

11.1 Grids

From the grid edit page you can change the layout of all your grids.

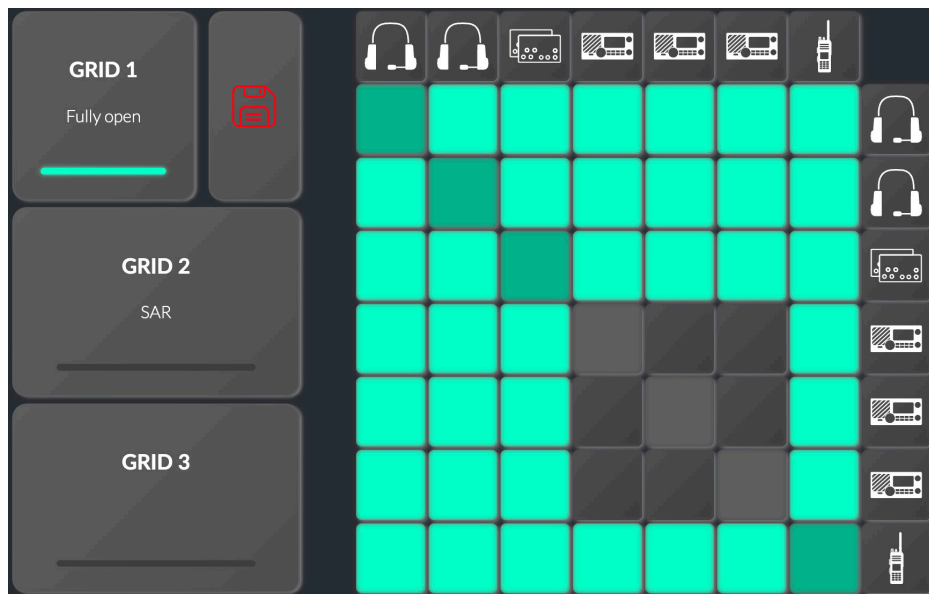

11.2 Save button

A save button will appear on the grid you have selected. If you make any changes to the grid the save button will turn red indicating you have unsaved changes. If you wish to save your changes, click the icon and it will turn white again. This is now your default on this grid.

Currently editing grid

Press to edit grid

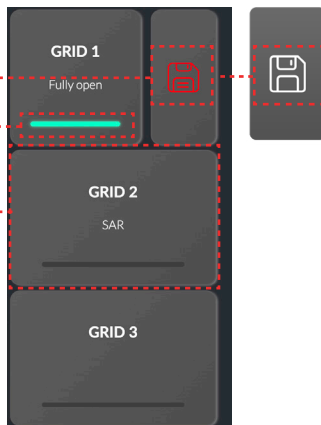

11.3 Grid Editing

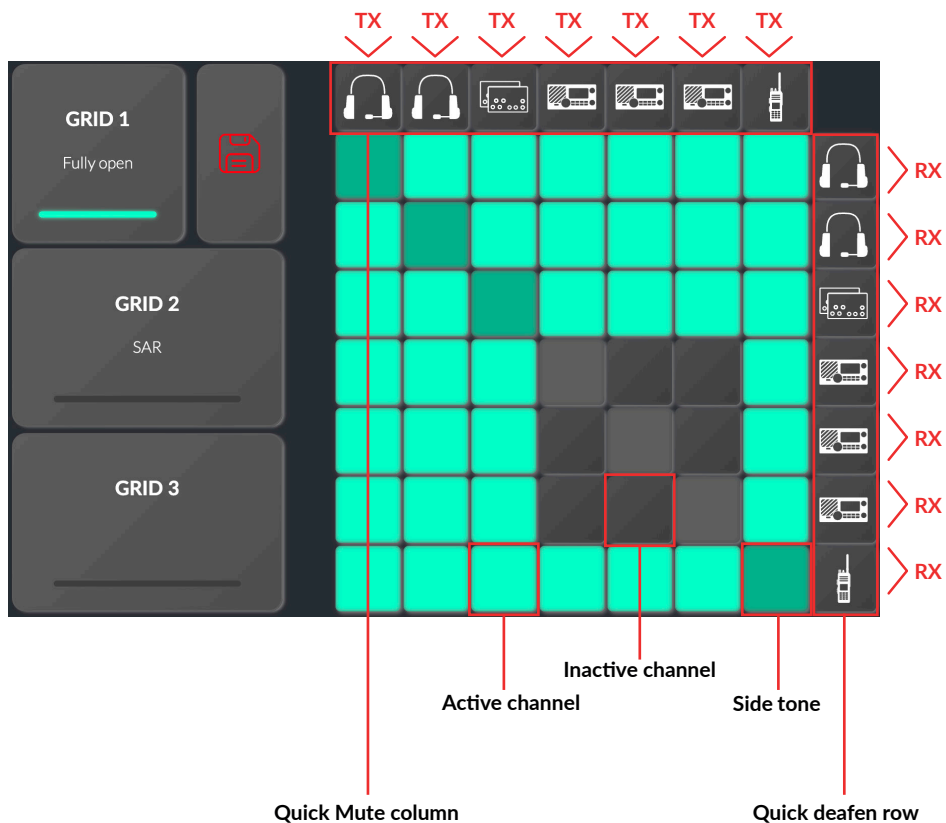

11.4 Grid Menu Bar

The menu bar in the interface adapts dynamically based on the site or page you are currently viewing. As you switch between different sites within the interface, the menu bar will reflect the context of each site

Back to home screen



13.1 Maintenance

Please refrain from using chemicals or solvents to clean your iriSelect Black Box. Instead, use a damp cloth with cold or lukewarm freshwater to carefully wipe and rinse the visible surfaces of the device.

If there are saltwater crystals present, you can remove them by rinsing the affected areas with cold or lukewarm freshwater. Be sure to rinse thoroughly to eliminate any salt residue.

Avoid applying excessive pressure, friction or using sharp objects on the product, as these can cause damage and potentially void the warranty. Additionally, if the iriSelect Black Box remains unused for an extended period, it is advisable to reconnect it and update to the latest software version.

The power connector, which is gold plated, requires minimal maintenance. To ensure a secure connection, remove any salt crystals by using cold or lukewarm water. Dry the connector using a cotton swab or soft tissue. For added protection, apply a thin layer of acid-free silicone-based lubricant on the conductive gold surface.

13.2 Updating iriSelect Black Box

IMPORTANT

Before doing anything you first need to determine, what version of the iriSelect Black Box you are working with. This is a very crucial step. If not paid attention to, your unit will not function correctly and there is no redo.

Fortunately this is very easy. Simply power on your iriSelect Black Box and look at the “STATUS LED”.



If the **STATUS LED** flashes **RED** you have a version 1 and should download the firmware 1.x.x

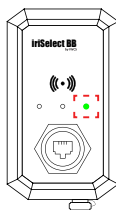

If the **STATUS LED** flashes **GREEN** you have a version 2 and should download the firmware 2.x.x

Download

Download the latest firmware compatible with your iriSelect Black Box from IWCS website and unzip the folder.

Connection

Connect the iriSelect Black Box to your PC, either via LAN cable to your router or wireless via its built-in WiFi "iriSelect Temp".

To turn on the WiFi, place and hold a magnet to the front of the iriSelect Black Box. The "STATUS LED" will start flashing rapidly.

Remove the magnet once the LED is steady **RED** or **GREEN** - Depending on the version

Connect to the "iriSelect Temp" WiFi. (There is no password)

Once connected, open a browser and type "iriSelect.local/update" in the search bar.

Installation

Click "Choose image" and select one of the two files you just unzipped. (it does not matter whether you start with the .BIN or the .IMG file)

Then click "update". It will say "success" when done.

You might lose connection when a file has successfully updated. Simply reconnect and continue to the next step.

Now click on "choose image" again and select the other file and click "update" and wait for "success".

Your iriSelect Black Box is now updated and ready to use.

13.3 Troubleshoot

Problem	Cause	Action
LAN Connection lost	Cable not fully inserted into iriSelect or MFD/ computer.	Turn off MFD/computer and iriSelect Black Box. Take the cables out and reinsert them. Look for any damage on the cables. boot up system again.
Wireless connection lost	The iriSelect Black Box has been turned off for a longer period of time.	Reconnect iriSelect to your MFD/ computer.
Wrong radio is TX'ing when PTT is pressed.	Wrong set-up	Go to the settings site, and make sure your radios channels match the the channels on your iriSound.
Cannot access settings site.	Lost WiFi connection to iriSelect Black Box	Reconnect your phone or computer to the iriSelectBB WiFi

14.1 Specifications

Specifications	iriSelect Black Box
Weight	246 g
Range (WiFi)	
Waterproof	IPX7, seawater resistant
Power source	iriSound
Temperature range	-15 to + 55 degrees Celsius
LAN	Ethernet 10/100 Mb
WiFi	802.11b
MIL-std-810g—Designed to meet	503.6 Temperature Shock, 505.6 Solar Radiation, 509.6 Salt Fog, 512.5 Immersion, 515.7 Acoustic Noise, 521.4 Icing/Freezing Rain 503.6 Temperature Shock, 505.6 Solar Radiation, 509.6 Salt Fog, 512.5 Immersion, 515.7 Acoustic Noise, 521.4 Icing/Freezing Rain

* Can be limited by the 3rd party connector specifications. Refer to 3rd party for accurate limitations.

14.2 Measurements

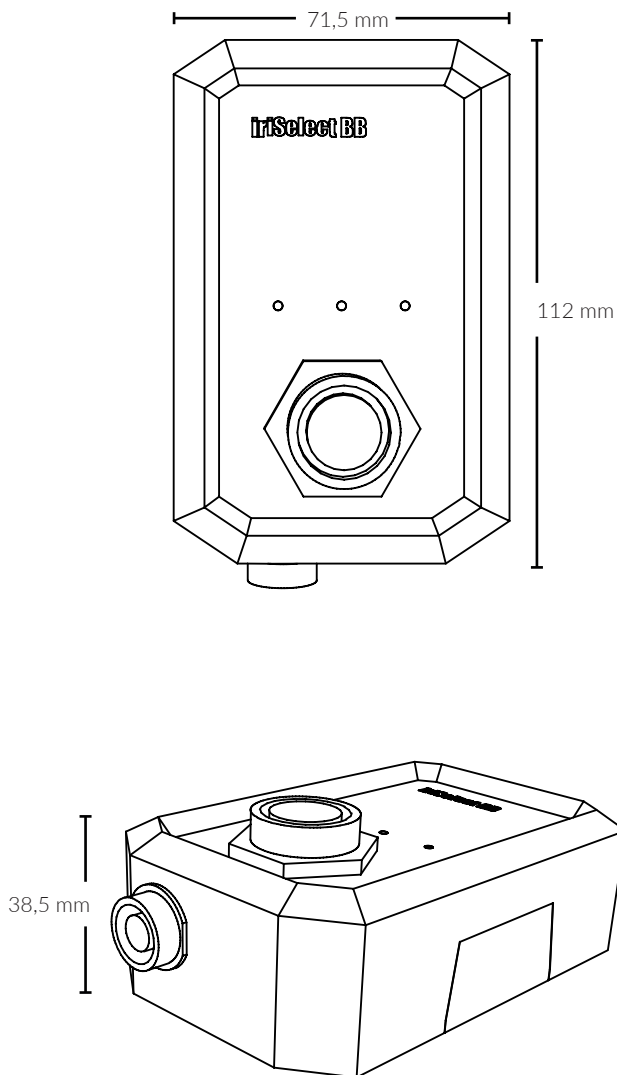

iriSelect Black Box
is developed, designed and
manufactured by

IWCS Aps

**Hejrevang 13
3470 Kvistgaard
Denmark**

+45 4343 2626

**Info@iwcs.eu
www.iwcs.eu**